

WELL TEST EQUIPMENT DESCRIPTION					
EQUIPMENT#	DESCRIPTION	DIMENSIONS (M)			WEIGHT (KGS)
		L	W	H	
1	SURFACE SAFETY VALVE	1.36	0.6	1.5	907
2	SAND FILTER	2.63	2.14	4.1	9,000
3	SAND FILTER	2.99	2.44	3.0	9,000
4	CHOKE MANIFOLD	2.64	2.43	1.1	4,309
5	HEATER	6.1	2.4	2.9	12,000
6	3 PHASE SEPARATOR	6.06	2.44	2.6	15,460
7	DUAL COMPARTMENT SURGE TANK	2.95	2.44	6.06	15,200
8	DUAL COMPARTMENT STOCK TANK	3.05	2.44	2.44	5,000
9	RELIEF KNOCK-OUT POT	3.05	2.44	5.79	5,000
10	GAS SCRUBBER & VENT	1.22	0.38	0.61	120
11	GAS KNOCK-OUT	1.84	1.65	4.0	2,100
12	SHROUDED GROUND FLARE	4.24	4.24	12.2	TBC
13	OIL DIVERter MANIFOLD	1.50	1.60	0.4	375
14	ENCLOSED SOLIDS HANDLING TANK	2.0	1.9	3.8	3,500
15	SOLID REMOVAL SILO	2.9	2.44	6.1	TBC
16	SWT WORKSHOP CONTAINER	3.04	2.43	2.6	8,000
17	WELL TEST LAB / DAQ CABIN	6.04	2.44	2.6	14,000
18	GENERATOR	TBC	TBC	TBC	TBC
19	COMPRESSOR	TBC	TBC	TBC	TBC

THE ORDNANCE SURVEY DATA ON THIS PLAN HAS BEEN REPRODUCED FROM ORDNANCE SURVEY © BY PERMISSION OF HER MAJESTY'S STATIONERY OFFICE. © CROWN COPYRIGHT 2019. ALL RIGHTS RESERVED. LICENCE No. 100022432

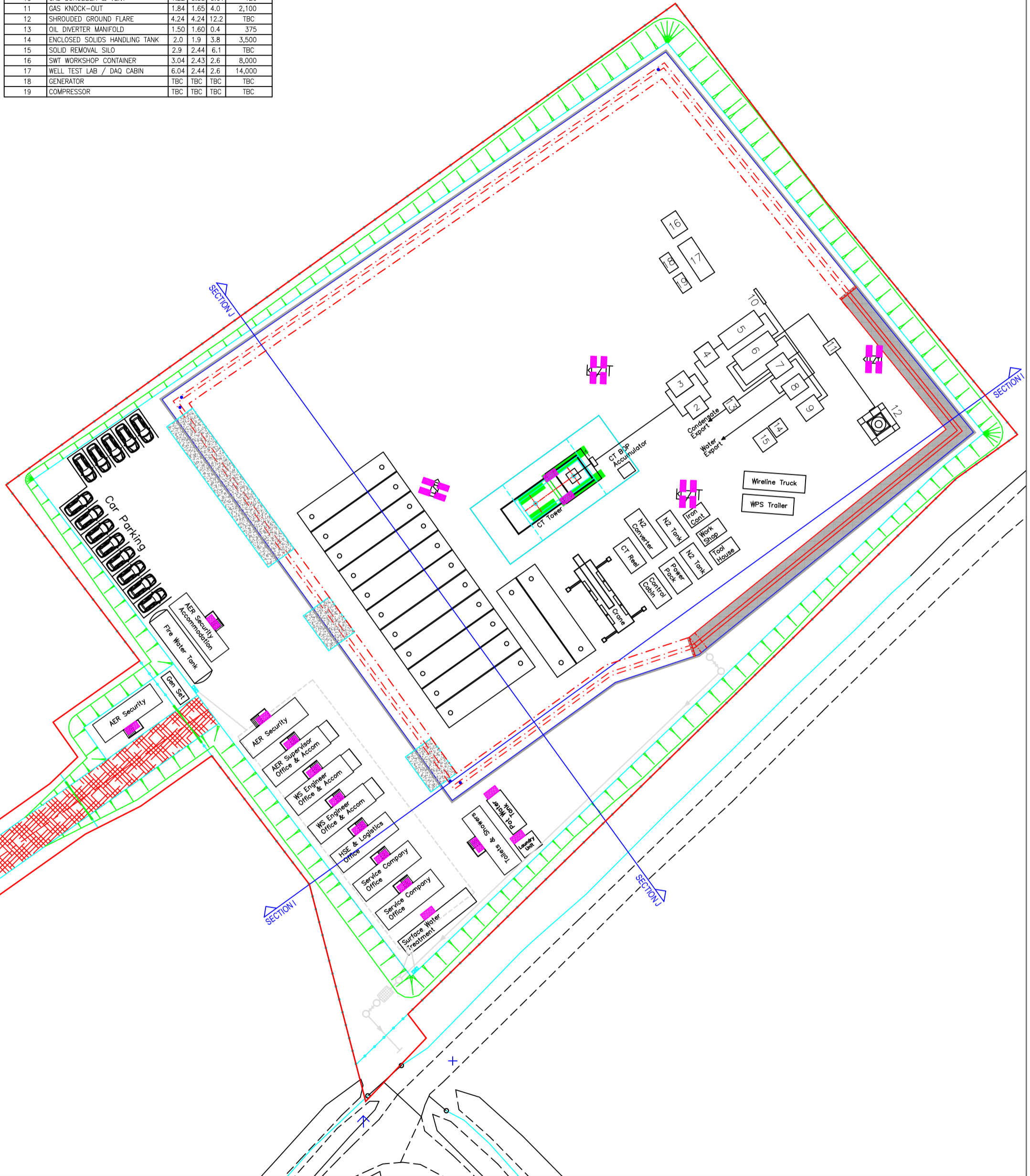

KEY:

PLANNING APPLICATION BOUNDARY	
HYDRULIC FRACTURING EQUIPMENT	

LIGHTING SPECIFICATION:

EXTERNAL EX LINEAR FLOURESCENT (2 x 36W)

EX FLOOD LIGHTS (400W)

PORTABLE LIGHTING TOWER (4 x 1000W METAL HALIDE)

REFER TO SECTION DRAWING: ZG-AER-ALT-PA-25

ZETLAND GROUP
FROM CONCEPTION TO COMPLETION

ZETLAND GROUP LIMITED
THE INNOVATION CENTRE, KIRKLEATHAM BUSINESS PARK, REDCAR, TS10 5SH
T: +44(0)1842 777728 E: info@zetlandgroup.com W: www.zetlandgroup.com

THIS DOCUMENT IS THE PROPERTY OF ZETLAND GROUP LIMITED. IT CONTAINS PROPRIETARY AND CONFIDENTIAL INFORMATION WHICH MUST NOT BE DUPLICATED, USED OR DISCLOSED OTHER THAN AS EXPRESSLY AUTHORISED BY ZETLAND GROUP LIMITED OR ITS REPRESENTATIVE © 2019

REVISION HISTORY				
-	-	-	-	-
-	-	-	-	-
-	-	-	-	-
0	MAY19	JF	FIRST ISSUE	JF
REV	DATE	BY	DETAILS	

SITE:	ALTCAR MOSS, GREAT ALTCAR, WEST LANCASHIRE
PROJECT:	APPLICATION FOR PLANNING PERMISSION
TITLE:	INITIAL FLOW TEST PHASE LAYOUT PLAN (BOREHOLE #1)
CLIENT:	AURORA ENERGY RESOURCES
Scale:	1:500
Size:	A3
Sheet:	1 of 1
DWG. No:	ZG-AER-ALT-PA-24